

# HIGHER FEDERAL TEACHING AND RESEARCH INSTITUTE TIROL

The Federal College for Higher Education and Research in Rotholz, Tyrol, is being built as a timber hybrid construction. The thermally high-quality building envelope, coupled with efficient building services and the 75 kWp photovoltaic system, secured the klimaaktiv building certification in gold for the school and boarding school components.

pde supported the project from planning to opening. Measures such as building product management, including HFC-free, PVC-free and low-emission building products, thermal comfort simulations and energy optimisation of the building envelope also helped to meet the customer's requirements from a single source. Finally, quality assurance was carried out by means of various measurements, such as BlowerDoor and indoor air pollutant measurements, as part of the klimaaktiv verification programme.



© Ronald Zecha

<b>Client</b>	Landwirtschaftliche Bundesversuchswirtschaften GmbH
<b>Location</b>	Rotholz
<b>pde period of service</b>	03/2018 – 06/2019
<b>Completion</b>	06/2019
<b>Service area</b>	General planning, Sustainability, BIM
<b>Dimensions</b>	Usable space: 29.000 m <sup>2</sup> ; 13 seminar rooms, conference hall, laboratory, teaching kitchens, dairy, boarding school, gymnasiums, sports ground, underground car park

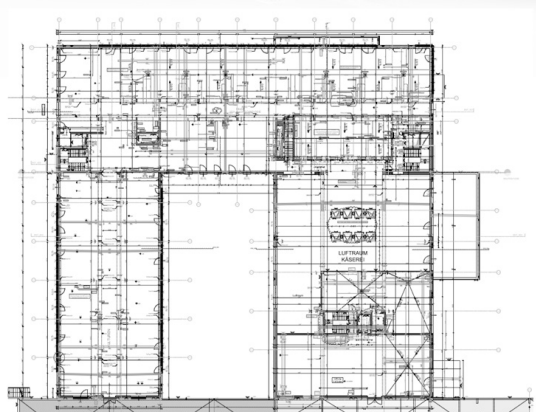

## UNIQUE IN AUSTRIA

The building complex provides space for a voluntary boarding school with 200 beds, the research and service centre and the HBLFA Tirol school.

Many pupils and around 250 teachers, researchers, staff and apprentices learn, teach and conduct research in Rotholz at the HBLFA Tirol, the vocational schools and the Rotholz regional training centre (technical college).

This makes Rotholz unique in Austria's agricultural education landscape.

## AWARDED THE „KLIMAAKTIV GOLD“ AND „SILVER“ STANDARD

The boarding school was awarded „klimaaktiv Gold“ status with 1000 out of a possible 1000 points. The new school building was also awarded „klimaaktiv Gold“ status with 943 out of a possible 1000 points.

The administration and research building (which could not be a timber construction due to HACCP requirements, among other things) achieved silver status.

### Special features:

- Timber hybrid construction with prefabrication
- PV system
- klimaaktiv Gold certification

**Vienna** pde Intergrale Planung GmbH  
Absberggasse 47  
1100 Vienna, Austria  
+43 50 626-0  
office.at@pde-porr.com

**Berlin** pde Intergrale Planung GmbH  
Valeska-Gert-Straße 1  
10243 Berlin, Germany  
+49 30 915 809 000  
office.de@pde-porr.com

Pictures: © pde